

ELEVATION CERTIFICATE

OMB No. 1660-0008
Expires March 31, 2012

Important: Read the instructions on pages 1-9.

SECTION A - PROPERTY INFORMATION		For Insurance Company Use
A1. Building Owner's Name		Policy Number
A2. Building Street Address (including Apt., Unit, Suite, and/or Bldg. No.) or P.O. Route and Box No. <u>607 3RD AVE</u>		Company NAIC Number
City <u>DECATUR</u>	State <u>GA</u>	ZIP Code <u>30030</u>
A3. Property Description (Lot and Block Numbers, Tax Parcel Number, Legal Description, etc.) <u>LOT 30, TUXEDO PARK SUBD, LAND LOT 213 DIST 15th, DEKALB COUNTY</u>		
A4. Building Use (e.g., Residential, Non-Residential, Addition, Accessory, etc.) <u>RESIDENTIAL</u>		
A5. Latitude/Longitude: Lat. <u>33° 45' 25.82" N</u> Long. <u>84° 18' 30.32" W</u> Horizontal Datum: <input type="checkbox"/> NAD 1927 <input checked="" type="checkbox"/> NAD 1983		
A6. Attach at least 2 photographs of the building if the Certificate is being used to obtain flood insurance.		
A7. Building Diagram Number <u>1B</u>		
A8. For a building with a crawlspace or enclosure(s):		A9. For a building with an attached garage:
a) Square footage of crawlspace or enclosure(s) <u>1509</u> sq ft		a) Square footage of attached garage <u>N/A</u> sq ft
b) No. of permanent flood openings in the crawlspace or enclosure(s) within 1.0 foot above adjacent grade <u>3</u>		b) No. of permanent flood openings in the attached garage within 1.0 foot above adjacent grade <u>N/A</u>
c) Total net area of flood openings in A8.b <u>311.04</u> sq in		c) Total net area of flood openings in A9.b <u>N/A</u> sq in
d) Engineered flood openings? <input type="checkbox"/> Yes <input checked="" type="checkbox"/> No		d) Engineered flood openings? <input type="checkbox"/> Yes <input checked="" type="checkbox"/> No

SECTION B - FLOOD INSURANCE RATE MAP (FIRM) INFORMATION

B1. NFIP Community Name & Community Number <u>DECATUR CITY & 135159</u>		B2. County Name <u>DEKALB</u>		B3. State <u>GA</u>	
B4. Map/Panel Number <u>13089C0068</u>	B5. Suffix <u>H</u>	B6. FIRM Index Date <u>MAY 7, 2001</u>	B7. FIRM Panel Effective/Revised Date <u>FEB 20, 2008</u>	B8. Flood Zone(s) <u>AE</u>	B9. Base Flood Elevation(s) (Zone AO, use base flood depth) <u>988.00</u>
B10. Indicate the source of the Base Flood Elevation (BFE) data or base flood depth entered in Item B9. <input checked="" type="checkbox"/> FIS Profile <input type="checkbox"/> FIRM Community Determined <input type="checkbox"/> Other (Describe) _____					
B11. Indicate elevation datum used for BFE in Item B9: <input checked="" type="checkbox"/> NGVD 1929 <input type="checkbox"/> NAVD 1988 <input type="checkbox"/> Other (Describe) _____					
B12. Is the building located in a Coastal Barrier Resources System (CBRS) area or Otherwise Protected Area (OPA)? Designation Date _____ <input type="checkbox"/> CBRS <input type="checkbox"/> OPA <input type="checkbox"/> Yes <input checked="" type="checkbox"/> No					

SECTION C - BUILDING ELEVATION INFORMATION (SURVEY REQUIRED)

C1. Building elevations are based on: Construction Drawings* Building Under Construction* Finished Construction
*A new Elevation Certificate will be required when construction of the building is complete.

C2. Elevations - Zones A1-A30, AE, AH, A (with BFE), VE, V1-V30, V (with BFE), AR, AR/A, AR/AE, AR/A1-A30, AR/AH, AR/AO. Complete Items C2.a-h below according to the building diagram specified in Item A7. Use the same datum as the BFE.

Benchmark Utilized RM 68-19 Vertical Datum 1001.62

Conversion/Comments CHISELED CROSS ON MANHOLE IN THE CENTER ON EASTLAKE DR

Check the measurement used.

a) Top of bottom floor (including basement, crawlspace, or enclosure floor)	<u>989.01</u> <input checked="" type="checkbox"/> feet	<input type="checkbox"/> meters (Puerto Rico only)
b) Top of the next higher floor	<u>995.69</u> <input checked="" type="checkbox"/> feet	<input type="checkbox"/> meters (Puerto Rico only)
c) Bottom of the lowest horizontal structural member (V Zones only)	<u>N/A</u> <input type="checkbox"/> feet	<input type="checkbox"/> meters (Puerto Rico only)
d) Attached garage (top of slab)	<u>N/A</u> <input type="checkbox"/> feet	<input type="checkbox"/> meters (Puerto Rico only)
e) Lowest elevation of machinery or equipment servicing the building (Describe type of equipment and location in Comments) <u>AC</u>	<u>993.27</u> <input checked="" type="checkbox"/> feet	<input type="checkbox"/> meters (Puerto Rico only)
f) Lowest adjacent (finished) grade next to building (LAG)	<u>989.95</u> <input checked="" type="checkbox"/> feet	<input type="checkbox"/> meters (Puerto Rico only)
g) Highest adjacent (finished) grade next to building (HAG)	<u>993.54</u> <input checked="" type="checkbox"/> feet	<input type="checkbox"/> meters (Puerto Rico only)
h) Lowest adjacent grade at lowest elevation of deck or stairs, including structural support	<u>990.12</u> <input checked="" type="checkbox"/> feet	<input type="checkbox"/> meters (Puerto Rico only)

SECTION D - SURVEYOR, ENGINEER, OR ARCHITECT CERTIFICATION

This certification is to be signed and sealed by a land surveyor, engineer, or architect authorized by law to certify elevation information. I certify that the information on this Certificate represents my best efforts to interpret the data available. I understand that any false statement may be punishable by fine or imprisonment under 18 U.S. Code, Section 1001.

Check here if comments are provided on back of form. Were latitude and longitude in Section A provided by a licensed land surveyor? Yes No

Certifier's Name EUGENE STEPANOV License Number 3197

Title REGISTERED LAND SURVEYOR Company Name SURVEY LAND EXPRESS INC

Address 10 Lenox Pointe City ATLANTA State GA ZIP Code 30324

Signature [Signature] Date 04/07/2011 Telephone 404-252-5747

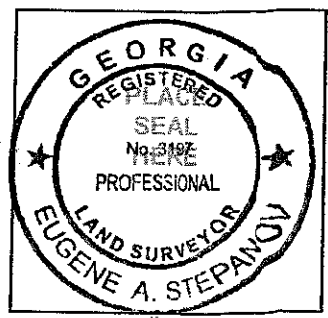

IMPORTANT: In these spaces, copy the corresponding information from Section A.		For Insurance Company Use	
Building Street Address (including Apt., Unit, Suite, and/or Bldg. No.) or P.O. Route and Box No. 607 3RD AVE		Policy Number	
City DECATUR	State GA	ZIP Code 30030	Company NAIC Number

SECTION D - SURVEYOR, ENGINEER, OR ARCHITECT CERTIFICATION (CONTINUED)

Copy both sides of this Elevation Certificate for (1) community official, (2) insurance agent/company, and (3) building owner.

Comments HOUSE IS NOT IN FLOOD.

Signature [Signature] Date 02/07/2011 Check here if attachments

SECTION E - BUILDING ELEVATION INFORMATION (SURVEY NOT REQUIRED) FOR ZONE AO AND ZONE A (WITHOUT BFE)

For Zones AO and A (without BFE), complete Items E1-E5. If the Certificate is intended to support a LOMA or LOMR-F request, complete Sections A, B, and C. For Items E1-E4, use natural grade, if available. Check the measurement used. In Puerto Rico only, enter meters.

- E1. Provide elevation information for the following and check the appropriate boxes to show whether the elevation is above or below the highest adjacent grade (HAG) and the lowest adjacent grade (LAG).
 - a) Top of bottom floor (including basement, crawlspace, or enclosure) is _____ feet meters above or below the HAG.
 - b) Top of bottom floor (including basement, crawlspace, or enclosure) is _____ feet meters above or below the LAG.
- E2. For Building Diagrams 6-9 with permanent flood openings provided in Section A Items 8 and/or 9 (see pages 8-9 of Instructions), the next higher floor (elevation C2.b in the diagrams) of the building is _____ feet meters above or below the HAG.
- E3. Attached garage (top of slab) is _____ feet meters above or below the HAG.
- E4. Top of platform of machinery and/or equipment servicing the building is _____ feet meters above or below the HAG.
- E5. Zone AO only: If no flood depth number is available, is the top of the bottom floor elevated in accordance with the community's floodplain management ordinance? Yes No Unknown. The local official must certify this information in Section G.

SECTION F - PROPERTY OWNER (OR OWNER'S REPRESENTATIVE) CERTIFICATION

The property owner or owner's authorized representative who completes Sections A, B, and E for Zone A (without a FEMA-issued or community-issued BFE) or Zone AO must sign here. *The statements in Sections A, B, and E are correct to the best of my knowledge.*

Property Owner's or Owner's Authorized Representative's Name _____

Address	City	State	ZIP Code
Signature	Date	Telephone	
Comments			

Check here if attachments

SECTION G - COMMUNITY INFORMATION (OPTIONAL)

The local official who is authorized by law or ordinance to administer the community's floodplain management ordinance can complete Sections A, B, C (or E), and G of this Elevation Certificate. Complete the applicable item(s) and sign below. Check the measurement used in Items G8 and G9.

- G1. The information in Section C was taken from other documentation that has been signed and sealed by a licensed surveyor, engineer, or architect who is authorized by law to certify elevation information. (Indicate the source and date of the elevation data in the Comments area below.)
- G2. A community official completed Section E for a building located in Zone A (without a FEMA-issued or community-issued BFE) or Zone AO.
- G3. The following information (Items G4-G9) is provided for community floodplain management purposes.

G4. Permit Number	G5. Date Permit Issued	G6. Date Certificate Of Compliance/Occupancy Issued
-------------------	------------------------	---

- G7. This permit has been issued for: New Construction Substantial Improvement
- G8. Elevation of as-built lowest floor (including basement) of the building _____ feet meters (PR) Datum _____
- G9. BFE or (in Zone AO) depth of flooding at the building site _____ feet meters (PR) Datum _____
- G10. Community's design flood elevation _____ feet meters (PR) Datum _____

Local Official's Name	Title
Community Name	Telephone
Signature	Date
Comments	

Check here if attachments

Building Photographs

See Instructions for Item A6. 221221

Building Street Address (including Apt., Unit, Suite, and/or Bldg. No.) or P.O. Route and Box No. 607 3rd Ave			For Insurance Company Use: Policy Number
City Decatur,	State GA	ZIP Code 30030	Company NAIC Number

If using the Elevation Certificate to obtain NFIP flood insurance, affix at least two building photographs below according to the instructions for Item A6. Identify all photographs with: date taken; "Front View" and "Rear View"; and, if required, "Right Side View" and "Left Side View." If submitting more photographs than will fit on this page, use the Continuation Page, following.

FRONT VIEW

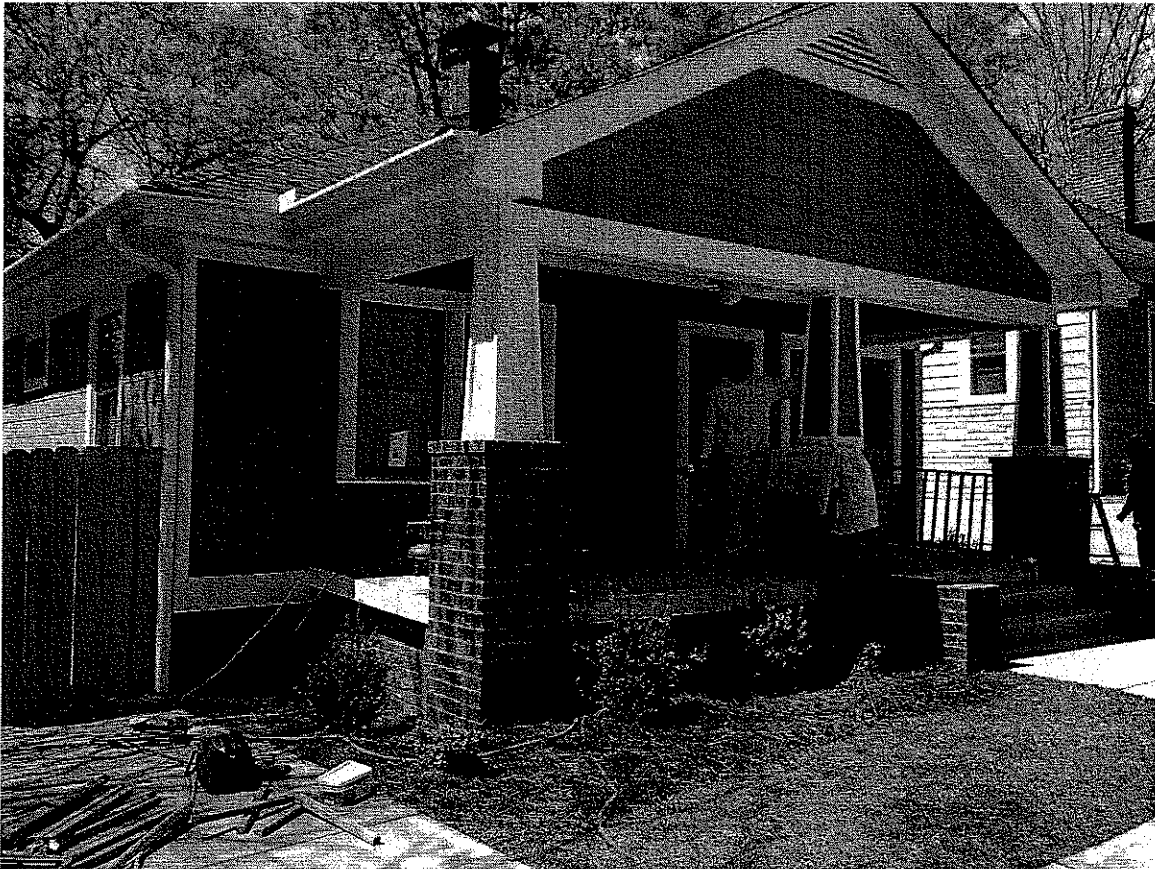

Building Photographs

See Instructions for Item A6. 221221

Building Street Address (including Apt., Unit, Suite, and/or Bldg. No.) or P.O. Route and Box No. 607 3rd Ave			For Insurance Company Use: Policy Number
City Decatur,	State GA	ZIP Code 30030	Company NAIC Number

If using the Elevation Certificate to obtain NFIP flood insurance, affix at least two building photographs below according to the instructions for Item A6. Identify all photographs with: date taken; "Front View" and "Rear View"; and, if required, "Right Side View" and "Left Side View." If submitting more photographs than will fit on this page, use the Continuation Page, following.

RIGHT SIDE VIEW



Building Photographs

See Instructions for Item A6. 221221

Building Street Address (including Apt., Unit, Suite, and/or Bldg. No.) or P.O. Route and Box No. 607 3rd Ave			For Insurance Company Use: Policy Number
City Decatur,	State GA	ZIP Code 30030	Company NAIC Number

If using the Elevation Certificate to obtain NFIP flood insurance, affix at least two building photographs below according to the instructions for Item A6. Identify all photographs with: date taken; "Front View" and "Rear View"; and, if required, "Right Side View" and "Left Side View." If submitting more photographs than will fit on this page, use the Continuation Page, following.

LEFT SIDE VIEW



Building Photographs

See Instructions for Item A6. 221221

Building Street Address (including Apt., Unit, Suite, and/or Bldg. No.) or P.O. Route and Box No. 607 3rd Ave			For Insurance Company Use: Policy Number
City Decatur,	State GA	ZIP Code 30030	Company NAIC Number

If using the Elevation Certificate to obtain NFIP flood insurance, affix at least two building photographs below according to the instructions for Item A6. Identify all photographs with: date taken; "Front View" and "Rear View"; and, if required, "Right Side View" and "Left Side View." If submitting more photographs than will fit on this page, use the Continuation Page, following.

REAR VIEW

