

EXISTING UTILITIES

- EXISTING GUY WIRE
- EX.OH ELECTRIC
- EX POWER POLE
- EX TRANSFORMER
- EX.UG ELECTRIC
- EX GAS LINE
- EX GAS METER
- EX GAS VALVE
- EX WATER LINE
- EX FIRE HYDRANT
- EX WATER METER
- EX WATER VALVE
- EX SANITARY SEWER
- EX SS MANHOLE
- EX TELEPHONE MH
- EX OH TELEPHONE
- EX TELEPHONE POLE
- EX UG TELEPHONE
- EX OH CABLE TV
- EX UG CABLE TV
- EX STORM DRAIN
- EX CATCH BASIN
- EX DROP INLET
- EX SD MANHOLE

EXISTING SIGNAL

- CONTROLLER CABINET
- STRAIN POLE
- TIMBER POLE
- DOWN GUY
- MAST ARM
- STREET LIGHT
- 3 SECTION HEAD
- 5 SECTION HEAD
- OVERHEAD SIGN
- PEDESTAL POLE
- PED SIGNAL HEAD
- CURB CUT RAMP
- PULLBOX, TP 1
- PULLBOX, TP 2
- PULLBOX, TP 4
- PULLBOX, TP 5
- 6x6 CALL LOOP
- 6x18 CALL LOOP
- 6x40 PRESENCE LOOP (DIPOLE)
- 6x40 PRESENCE LOOP (QUADRUPOLE)
- CONDUIT
- RAILROAD CONTROLLER
- SIGN POST

PROPOSED SIGNAL

- CONTROLLER CABINET
- STRAIN POLE
- TIMBER POLE
- DOWN GUY
- MAST ARM
- STREET LIGHT
- 3 SECTION HEAD
- 3 SECTION HEAD W/ BACKPLATE
- 4 SECTION HEAD
- 4 SECTION HEAD W/ BACKPLATE
- 5 SECTION HEAD
- 5 SECTION HEAD W/ BACKPLATE
- OVERHEAD STREET NAME SIGN
- OVERHEAD SIGN
- PEDESTAL POLE
- PED SIGNAL HEAD
- CURB CUT RAMP
- PULLBOX, TP 2
- PULLBOX, TP 3
- PULLBOX, TP 4
- PULLBOX, TP 6
- PULLBOX, TP 7
- 6x6 PULSE LOOP
- 6x18 CALL LOOP
- 6x40 PRESENCE LOOP (DIPOLE)
- 6x40 PRESENCE LOOP (QUADRUPOLE)
- CONDUIT (BORED)
- CONDUIT (TRENCHED)
- RAILROAD CONTROLLER
- SIGN POST
- ELECTRICAL SERVICE POINT
- RADAR DETECTION DEVICE
- MAGNETOMETER DETECTION DEVICE
- VIDEO DETECTION DEVICE
- VIRTUAL DETECTION ZONE (RADAR, VIDEO, ETC.)

PROPERTY AND EXISTING R/W LINE		BEGIN LIMIT OF ACCESS.....BLA	
REQUIRED R/W LINE		END LIMIT OF ACCESS.....ELA	
CONSTRUCTION LIMITS		LIMIT OF ACCESS	
EASEMENT FOR CONSTR & MAINTENANCE OF SLOPES		REQ'D R/W & LIMIT OF ACCESS	
EASEMENT FOR CONSTR OF SLOPES			
EASEMENT FOR CONSTR OF DRIVES			



REVISION DATES		SIGNAL PLANS	
		S COLUMBIA DR AT TALLEY ST/SHADOWMOOR DR	
		LEGEND	
CHECKED:	DATE:	DRAWING No.	
BACKCHECKED:	DATE:	27-001	
CORRECTED:	DATE:		
VERIFIED:	DATE:		

TRAFFIC SIGNAL GENERAL NOTES

1. THE COMPLETE SIGNAL INSTALLATION SHALL CONFORM TO ALL APPROPRIATE PARTS OF THE MANUAL ON UNIFORM TRAFFIC CONTROL DEVICES, CURRENT EDITION.
2. SIGNAL HEADS SHALL BE ERECTED TO PROVIDE AT LEAST 17 FEET BUT NO MORE THAN 19 FEET CLEARANCE FROM BOTTOM OF SIGNAL HEADS TO TOP OF ROAD SURFACE AND A MINIMUM OF 8 FEET MEASURED HORIZONATALLY BETWEEN CENTERS OF SIGNAL FACES.
3. SHIELDED CABLE WILL BE USED FOR DETECTOR RUNS AS SHOWN ON THE DETAIL SHEET. DETECTORS SHALL HAVE SEPERATE LEAD-INS TO THE CONTROLLER CABINET.
4. THE CONTRACTOR SHALL LOCATE UNDERGROUND AND OVERHEAD UTILITIES IN VICINITY OF NEW TRAFFIC SIGNAL POLES PRIOR TO ORDERING. AT THE DISCRETION OF THE ENGINEER, MINOR SHIFTS (UP TO 5 FEET, MAXIMUM) IN LOCATION OF NEW SIGNAL POLES ARE ACCEPTABLE TO AVOID UNDERGROUND AND OVERHEAD UTILITIES. MINIMUM CLEARANCES FROM EDGE OF PAVEMENT SHALL BE MAINTAINED. PLACEMENT OF THE SIGNAL HEADS SHALL BE RETAINED AS SHOWN ON THE PLANS.
5. THE CONTRACTOR SHALL MAINTAIN EXISTING TRAFFIC SIGNALS DURING CONSTRUCTION. THE CONTRACTOR SHALL MAINTAIN EXISTING VEHICLE DETECTION AND BE RESPONSIBLE FOR ALL TRAFFIC SIGNAL AND/OR CONTROL SYSTEM ADJUSTMENTS, INCLUDING TEMPORARY SUPPORT POLE LOCATION(S) REQUIRED BY THE PROJECT DURING THE INTERIM PERIOD THROUGH INSTALLATION OF NEW SIGNAL EQUIPMENT. AT NO TIME SHALL THE CONTRACTOR CAUSE ANY PART OF THE SIGNAL OPERATION TO BE INOPERABLE. PAYMENT SHALL BE INCLUDED IN PAY ITEM 647-1000 TRAFFIC SIGNAL INSTALLATION, FOR EACH INTERSECTION.
6. THE CONTRACTOR WILL BE RESPONSIBLE FOR ALL NEW GUYS ON EXISTING UTILITY TIMBER POLES WHEN ATTACHING SPAN WIRE OR INTERCONNECT CABLE TO THE POLES UNLESS OTHERWISE DIRECTED BY THE ENGINEER.
7. INSTALLATION OF TRAFFIC SIGNAL AT THIS INTERSECTION IS TO BE CHECKED AND ACCEPTED BY THE DEKALB COUNTY TRAFFIC ENGINEER PRIOR TO FINAL ACCEPTANCE.
8. WHEN REMOVED, EXISTING EQUIPMENT SHALL BE DELIVERED AND UNLOADED BY THE CONTRACTOR TO THE DEKALB COUNTY DEPARTMENT OF PUBLIC WORKS. CONTACT THE DEPARTMENT OF PUBLIC WORKS AT (404) 371-4778.
9. FOR STRAIN POLE FOUNDATION SIZE AND REINFORCEMENT, SEE STRAIN POLE AND MAST ARM POLE FOUNDATION SHEET, GDOT DETAIL TS-06.
10. MATERIAL CERTIFICATION IS REQUIRED PRIOR TO BEGINNING ANY SIGNAL INSTALLATION WORK.
11. ALL EXISTING STOP BARS, WORDS, ARROWS AND CROSSWALKS THAT ARE NOT REMOVED OR RELOCATED SHALL BE REPLACED IN ACCORDANCE WITH CURRENT GDOT STANDARDS.
12. ATTACHMENT HEIGHTS SHALL BE FIELD DETERMINED BY INSTALLER TO PROVIDE REQUIRED SIGNAL HEAD MOUNTING HEIGHTS AND CLEARANCE FROM EXISTING UTILITIES.
13. SAWCUTS AND REMOVAL OF ALL CONCRETE ASSOCIATED WITH CURB CUT RAMPS SHALL BE INCLUDED IN THE SIDEWALK PAY ITEM.
14. THE CONTRACTOR SHALL REPLACE IN KIND AND SIZE, AT NO SEPARATE EXPENSE TO THE CITY OF DECATUR, ANY BARRIER WALL, FENCE, DITCH PAVING, CURBING, SIDEWALK, GUTTER, SLOPE PAVEMENT, SIGNS, GAURDRAILS, LANDSCAPING, GRASSINGS, UTILITY SERVICE LINES, STORM DRAIN PIPES, MASONRY WALLS AND PAVING THAT IS REMOVED, DAMAGED OR DESTROYED DUE TO CONTRACTOR'S ACTIVITIES.
15. THE CONTRACTOR WILL BE RESPONSIBLE FOR ALL FEES ASSOCIATED WITH MODIFYING AND ESTABLISHING NEW POWER AND COMMUNICATIONS SERVICES FOR TRAFFIC SIGNALS, DETECTION SYSTEMS AND/OR CCTV CAMERAS ON THIS PROJECT. IF A UTILITY TRANSFORMER IS REQUIRED FOR TRAFFIC SIGNAL EQUIPMENT, IT IS THE RESPONSIBILITY OF THE CONTRACTOR TO INCLUDE THE COST, AS PART OF THEIR BID PRICE, FOR THAT TRAFFIC SIGNAL INSTALLATION, IF THE RESPECTIVE UTILITY REQUIRES PAYMENT FOR INSTALLATION.
16. THE CONTRACTOR WILL BE RESPONSIBLE FOR ALL MONTHLY POWER AND COMMUNICATION SERVICE TO THE TRAFFIC SIGNAL INSTALLATION AND SUPPORT DEVICES, UNTIL THE NEW TRAFFIC SIGNAL INSTALLATION HAS SATISFACTORALLY COMPLETED A TEST PERIOD, 30 DAYS, OF UNINTERRUPTED OPERATION. THE CONTRACTOR WILL COMPLETE A TRANSFER OF UTILITY COST TO DEKALB COUNTY (THE MAINTAINING AGENCY).
17. ALL INTERSECTIONS SHALL BE SET TO AN ALL RED FLASH FOR EACH APPROACH.
18. TRAFFIC SIGNAL HEADS, PEDESTRIAN SIGNAL HEADS, AND ALL ASSOCIATED HARDWARE SHALL BE BLACK IN COLOR.
19. ALL STRAIN POLES, MAST ARMS, AND PEDESTRIAN PEDESTAL POLES SHALL HAVE A BLACK POWDER-COAT FINISH.
20. PRIOR TO COMMENCEMENT OF CONSTRUCTION, THE CONTRACTOR SHALL CONTACT THE DEKALB COUNTY DEPARTMENT OF PUBLIC WORKS AT (404) 371-4778.



Know what's below.
Call before you dig.



REVISION DATES

NO.	DATE	DESCRIPTION

SIGNAL PLANS

S COLUMBIA DR AT TALLEY ST/SHADOWMOOR DR

GENERAL NOTES

CHECKED:	DATE:	DRAWING No.
BACKCHECKED:	DATE:	27-002
CORRECTED:	DATE:	
VERIFIED:	DATE:	

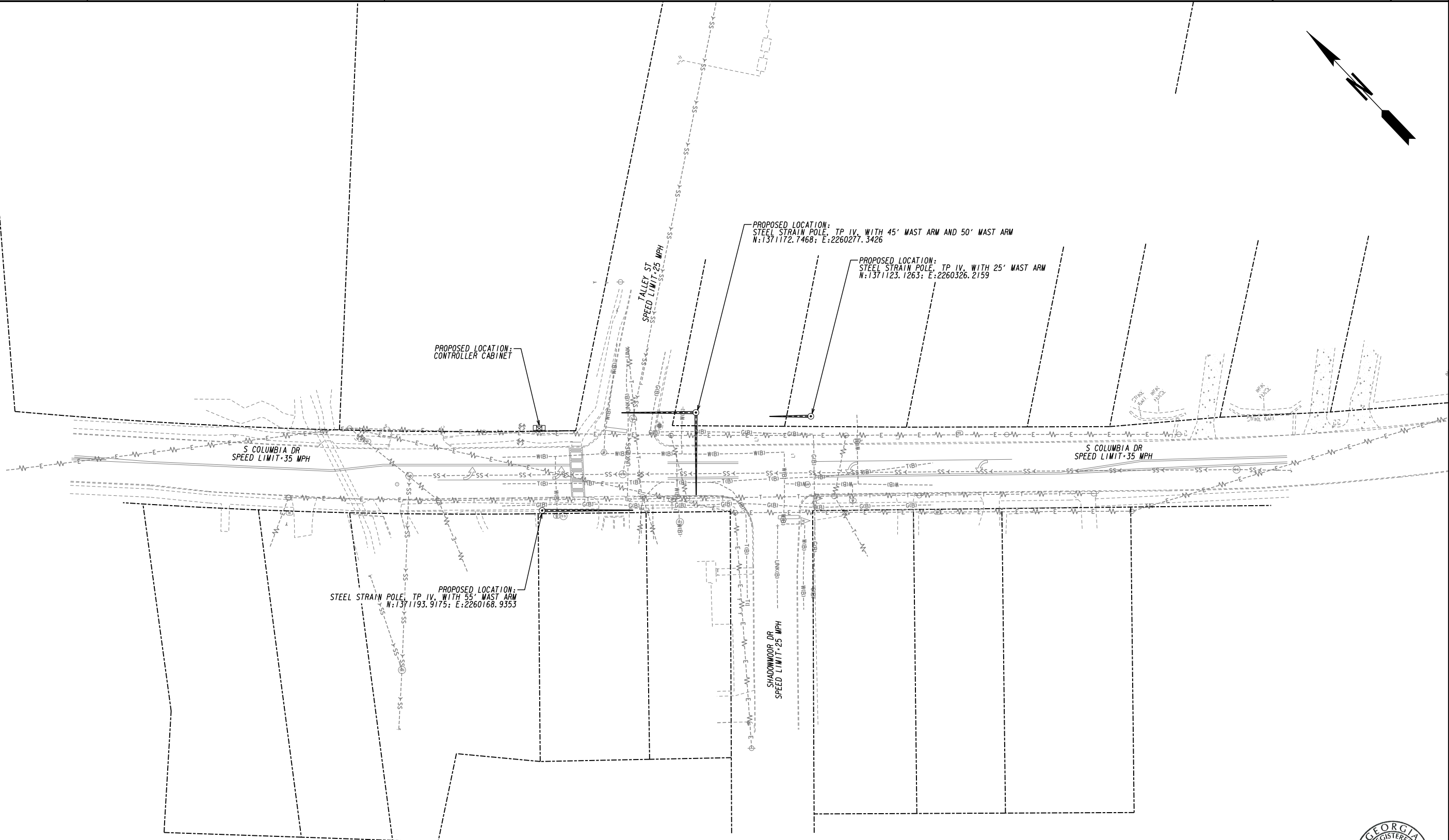
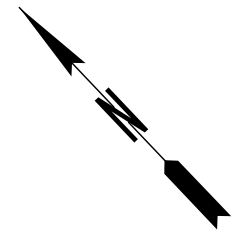

SIGNAL LEGEND

➔	PROPOSED SIGNAL HEAD	➔➔➔	PROPOSED 4-SECTION SIGNAL HEAD
---➔	EXISTING SIGNAL HEAD	➔➔➔➔	PROPOSED 5-SECTION OR 4-SECTION SIGNAL HEAD
➔➔	RELOCATED SIGNAL HEAD	⊕	PEDESTRIAN SIGNAL HEAD

DETECTION LEGEND

	PROPOSED VIRTUAL DETECTION ZONE		PROPOSED VIDEO DETECTION CAMERA
	PROPOSED INDUCTIVE LOOP		PROPOSED RADAR
	PROPOSED MAGNETOMETER		

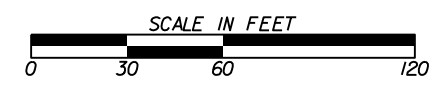

REVISION DATES

NO.	DATE	DESCRIPTION

SIGNAL PLANS
EXISTING CONDITIONS
S COLUMBIA DR AT TALLEY ST/SHADOWMOOR DR

CHECKED:	DATE:	DRAWING No.
BACKCHECKED:	DATE:	27-003
CORRECTED:	DATE:	
VERIFIED:	DATE:	

PHASING DIAGRAM

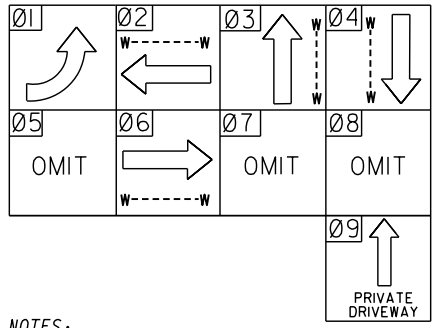

NOTES:
1. LEADING PEDESTRIAN INTERVALS MAY BE IMPLEMENTED FOR ALL PEDESTRIAN PHASES. CONTRACTOR SHALL COORDINATE WITH DEKALB COUNTY TO OBTAIN TIMING PLANS AT TIME OF IMPLEMENTATION.
2. PEDESTRIAN PHASES P3 AND P4 SHALL BE PROGRAMMED SUCH THAT THEY RUN CONCURRENTLY WITH PRIMARY PHASES, AS WELL AS EXCLUSIVELY. CONTRACTOR SHALL COORDINATE WITH DEKALB COUNTY TO OBTAIN TIMING PLANS AT TIME OF IMPLEMENTATION.

LED SIGNAL HEADS WITH RETRO-REFLECTIVE BACK PLATE

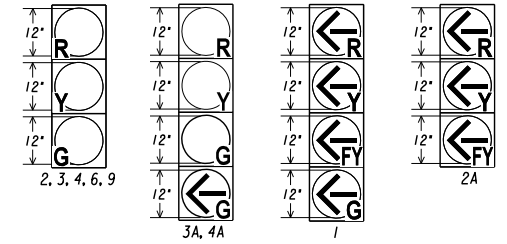

PEDESTRIAN LED SIGNAL HEADS WITH COUNTDOWN

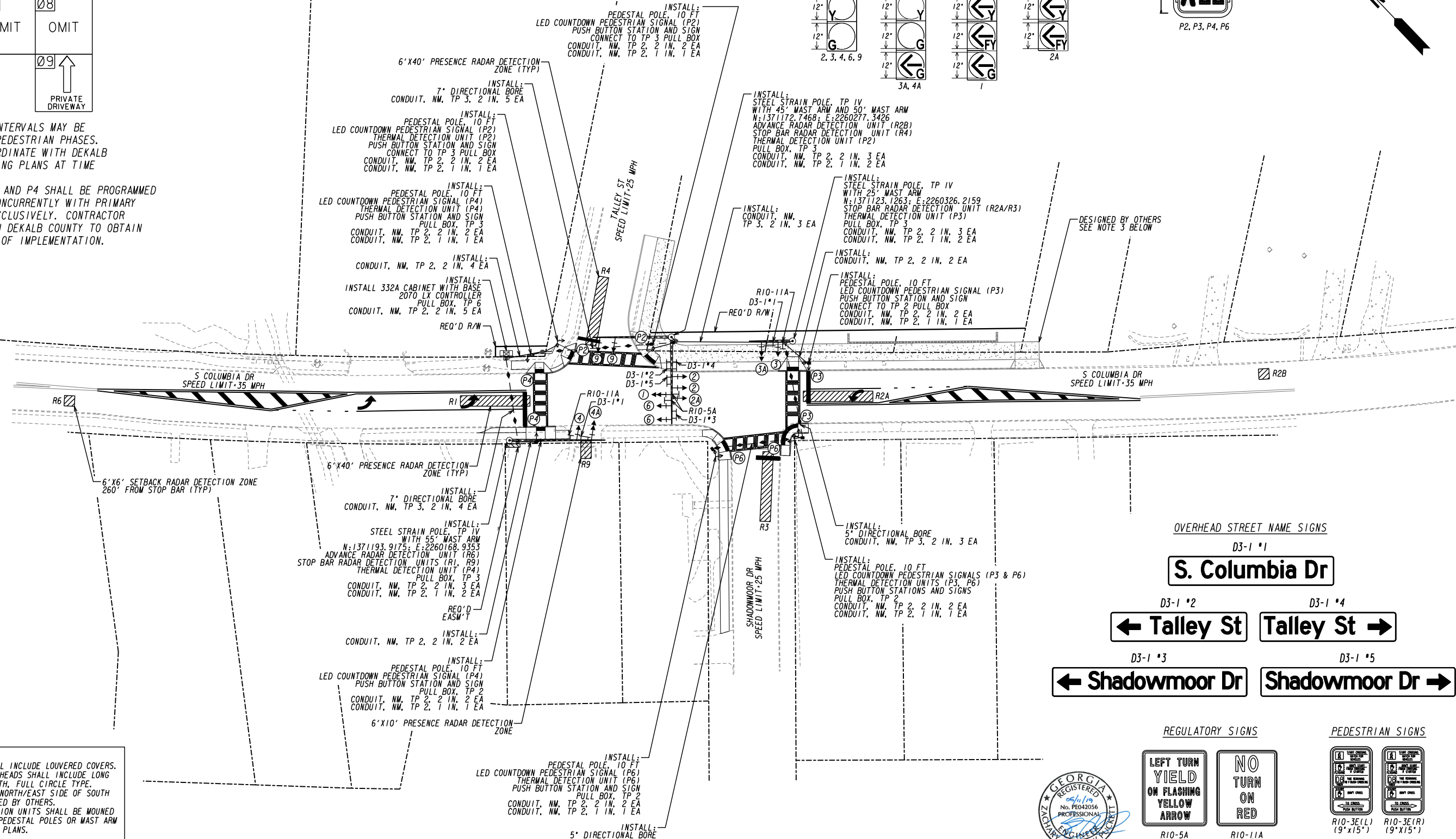
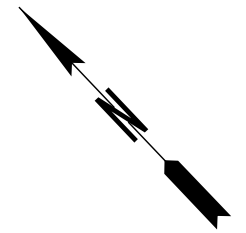
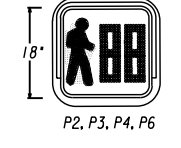

NOTES:
1. PHASE 9 SIGNAL HEADS SHALL INCLUDE LOUVERED COVERS.
2. PHASE 2, 6, AND 1 SIGNAL HEADS SHALL INCLUDE LONG VISORS - MINIMUM 12" LENGTH, FULL CIRCLE TYPE.
3. ALL PROPOSED WORK ON THE NORTH/EAST SIDE OF SOUTH COLUMBIA DRIVE IS DESIGNED BY OTHERS.
4. PEDESTRIAN THERMAL DETECTION UNITS SHALL BE MOUNTED AT THE TOP OF ASSOCIATED PEDESTAL POLES OR MAST ARM ASSEMBLY, AS SPECIFIED IN PLANS.

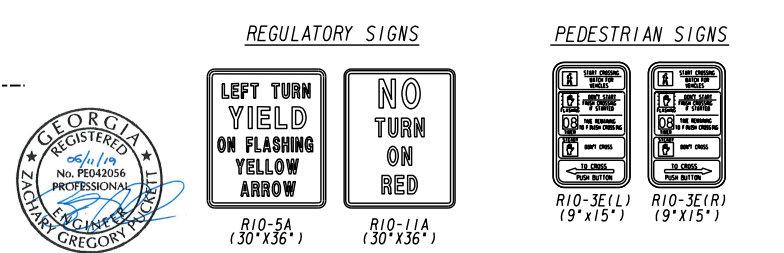
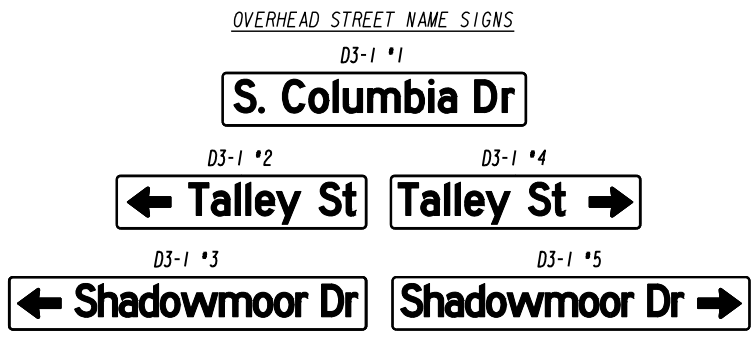

SIGNAL LEGEND

➔	PROPOSED SIGNAL HEAD	➔➔	PROPOSED 4-SECTION SIGNAL HEAD
➔➔	EXISTING SIGNAL HEAD	➔➔➔	PROPOSED 5-SECTION OR 4-SECTION SIGNAL HEAD
➔➔	RELOCATED SIGNAL HEAD	⊕	PEDESTRIAN SIGNAL HEAD

DETECTION LEGEND

	PROPOSED VIRTUAL DETECTION ZONE
	PROPOSED INDUCTIVE LOOP
	PROPOSED VIDEO DETECTION CAMERA
	PROPOSED MAGNETOMETER
	PROPOSED RADAR

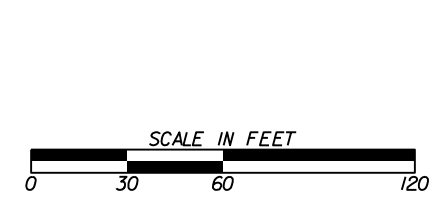
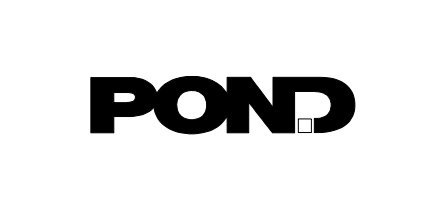

REVISION DATES

SIGNAL PLANS

TRAFFIC SIGNAL INSTALLATION NO. 1
S COLUMBIA DR AT TALLEY ST/SHADOWMOOR DR

CHECKED:	DATE:	DRAWING No. 27-004
BACKCHECKED:	DATE:	
CORRECTED:	DATE:	
VERIFIED:	DATE:	

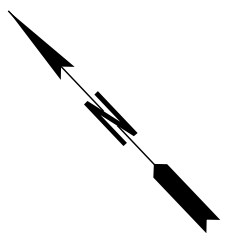

EXISTING CATCH BASIN RELOCATION WILL BE DESIGNED BY OTHERS.
PLEASE NOTE THAT THIS CONSTRUCTION MUST TAKE PLACE BEFORE
WHEELCHAIR RAMP/SIDEWALK CONSTRUCTION.

WHEELCHAIR RAMP, TYPE B (TYP)
GDOT DETAIL A3/A4
TIE INTO EXISTING SIDEWALK
N: 1371215.5588
E: 2260227.1371

N: 1371213.2435
E: 2260246.8222

N: 1371221.4961
E: 2260212.1784

REMOVE EXISTING:
W11-2 AND W16-7P SIGN ASSEMBLY
R1-1 SIGN ASSEMBLY
D3-1 SIGN ASSEMBLY

5' CONCRETE SIDEWALK
TIE INTO EXISTING DRIVEWAY
N: 1371226.2524
E: 2260201.2425

5' SOLID DOUBLE YELLOW WITH TYPE 1 YELLOW RPMS
AT 40' SPACING (TYP)

5' SOLID WHITE WITH TYPE 3 C/R RPMS
AT 20' SPACING (TYP)

5' SKIP WHITE (2' SEG., 6' GAP)
(TYP)

REQ'D 103 SY THERMOPLASTIC
STRIPING, YELLOW, DETAIL 'B'

ARROW, TYPE 1
(TYP)

REQ'D R/W

DESIGNED BY OTHERS
SEE NOTE 1 BELOW

SEE NOTE 2 BELOW
(TYP)

REMOVE EXISTING:
W11-2 AND W16-9P SIGN ASSEMBLY

REQ'D R/W

S COLUMBIA DR

S COLUMBIA DR

10' W(B)

10.5' T(B)

10' W(B)

10.5'

8.75' T(B)

10.5'

N: 1371097.8820
E: 2260254.1355

N: 1371082.8270
E: 2260300.3328

N: 1371078.7821
E: 2260296.2405

N: 1371076.2448
E: 2260279.8671

N: 1371080.5667
E: 2260275.7051

24" SOLID WHITE
(TYP)

TIE INTO EXISTING STRIPING
SEE NOTE 2 BELOW

8" SOLID WHITE
SEE GDOT DETAIL T-11A
(TYP)

REQ'D 90 SY THERMOPLASTIC
STRIPING, YELLOW, DETAIL 'B'

TIE INTO EXISTING STRIPING
SEE NOTE 2 BELOW

REMOVE EXISTING:
W11-2 AND W16-9P SIGN ASSEMBLY

INSTALL CONCRETE EXTENSION BETWEEN
EXISTING SIDEWALK AND B.O.C.
N: 1371209.9754
E: 2260158.3754

REQ'D EASMT

N: 1371193.1909
E: 2260181.3304

N: 1371187.3148
E: 2260175.9017

WHEELCHAIR RAMP, TYPE B
GDOT DETAIL A3/A4
TIE INTO EXISTING SIDEWALK

REMOVE EXISTING:
W11-2 AND W16-7P SIGN ASSEMBLY
PROTECT EXISTING MAILBOX

5' CONCRETE SIDEWALK
TIE INTO EXISTING DRIVEWAY
N: 1371170.8765
E: 2260194.4315

CONCRETE SIDEWALK
TIE INTO EXISTING SIDEWALK
N: 1371119.0830
E: 2260250.8324

WHEELCHAIR RAMP, TYPE B (MODIFIED)
GDOT DETAIL A3/A4
R-9.5'

BEGIN 5' CONCRETE SIDEWALK
N: 1371102.6913
E: 2260248.4061

PROTECT EXISTING SIGN ASSEMBLY

2' GRASS STRIP (TYP)

PROTECT EXISTING MAILBOX

PROTECT EXISTING S1-1 SIGN ASSEMBLY

END 5' CONCRETE SIDEWALK
N: 1371029.8759
E: 2260180.3666

SHADOWMOOR DR

NOTES:
1. ALL PROPOSED WORK ON THE NORTH/EAST SIDE OF SOUTH COLUMBIA
DRIVE IS TO BE DESIGNED/CONSTRUCTED BY OTHERS.
2. ALL EXISTING STRIPING FROM (N: 1371378.5086;E: 2260017.6376)
TO (N: 1370960.6328;E: 2260447.5042) AND/OR ANY STRIPING
CONFLICTING WITH PROPOSED STRIPING SHALL BE ERADICATED. PAYMENT
SHALL BE INCLUDED IN PAY ITEM 150-1000 TRAFFIC CONTROL.

PROPERTY AND EXISTING R/W LINE	-----E-----
REQUIRED R/W LINE	-----C-----
CONSTRUCTION LIMITS	-----F-----
EASEMENT FOR CONSTR & MAINTENANCE OF SLOPES	[Hatched Box]
EASEMENT FOR CONSTR OF SLOPES	[Hatched Box]
EASEMENT FOR CONSTR OF DRIVES	[Hatched Box]

BEGIN LIMIT OF ACCESS.....BLA	---o---o---o---
END LIMIT OF ACCESS.....ELA	---o---o---o---
REQ'D LIMIT OF ACCESS	---o---o---o---
REQ'D LIMIT OF ACCESS & R/W	---o---o---o---
ORANGE BARRIER FENCE	---o---o---o---
ESA - ENV. SENSITIVE AREA (SEE ERIT TABLE)	---o---o---o---

POND



REVISION DATES	

SIGNAL PLANS		
ROADWAY/SIGNING AND MARKING DETAILS		
S COLUMBIA DR AT TALLEY ST/SHADOWMOOR DR		
CHECKED:	DATE:	DRAWING No.
BACKCHECKED:	DATE:	27-005
CORRECTED:	DATE:	
VERIFIED:	DATE:	



LIST OF MATERIALS

LIST OF MATERIALS IS FOR INFORMATION PURPOSES ONLY. THE CONTRACTOR SHALL FIELD VERIFY ALL MATERIALS AND QUANTITIES REQUIRED FOR INSTALLATION.

MATERIALS	UNIT	QUANTITY
CABINET CONTROLLER ASSEMBLIES		
A. CONTROLLER UNIT, MODEL 2070LX	EA	1
E. CABINET ASSEMBLY, MODEL 332A	EA	1
F. SWITCH PACK (LOAD SWITCH)	EA	10
G. DC ISOLATOR	EA	3
L. 2010 SIGNAL MONITOR, TYPE B (ETHERNET)	EA	1
W. AUXILIARY OUTPUT FILE	EA	1
332 PREFABRICATED CONTROLLER CABINET BASE	EA	1
PC642-200 (OR EQUIVALENT), SURGE PROTECTOR	EA	1
LOOP/PEL LEAD-IN WIRE (SHIELDED, TWISTED/1000 FT)		
A. 3 PAIR (18 AWG)	REEL	1
SIGNAL CABLE (14 AWG)		
A. 7 CONDUCTOR, PER 1000 FT	REEL	3
3-SECTION, 12" SIGNAL HEAD LED, BLACK HOUSING W/BLACK FRONT, PLASTIC	EA	9
4-SECTION, 12" SIGNAL HEAD LED, BLACK HOUSING W/BLACK FRONT, PLASTIC	EA	3
1-SECTION, 16"x18" LED COUNTDOWN PEDESTRIAN SIGNAL HEAD, FULL HAND/MAN OVERLAP (9" HIGH NUMBER & 12" SYMBOLS)	EA	8
PEDESTRIAN PUSH BUTTON STATIONS, W/ BUTTONS AND SIGNS: 9"x15", R10-3E, (L)LEFT OR (R)RIGHT, COUNTDOWN		
1. 9"x15", R10-3EL, COUNTDOWN	EA	4
2. 9"x15", R10-3ER, COUNTDOWN	EA	4
BACKPLATE FOR ONE-WAY, 3 SECTION, 12" SIGNAL HEAD, ABS PLASTIC, BLACK W/ RETROREFLECTIVE STRIP	EA	9
BACKPLATE FOR ONE-WAY, 4 SECTION, 12" SIGNAL HEAD, ABS PLASTIC, BLACK W/ RETROREFLECTIVE STRIP	EA	3
HARDWARE FOR MAST ARM MOUNTING	EA	12
HARDWARE FOR PEDESTAL POLE, SIDE OF POLE MOUNTING, ONE-WAY BRACKET ASSEMBLY (CLAMSHELL)	EA	8
10" PEDESTAL POLE & SQUARE BASE (POWDER-COAT BLACK FINISH)	EA	7
PULL BOX, PB-2	EA	4
PULL BOX, PB-3	EA	4
PULL BOX, PB-6	EA	1
CONDUIT, 1"	LF	70
CONDUIT, 2"	LF	240
R10-5A, LEFT TURN YIELD ON FLASHING YELLOW SIGN	EA	2
R10-11A, NO TURN ON RED SIGN	EA	2
MISC. MATL. TO COMPLETE INSTALLATION	LUMP SUM	LUMP SUM

PAY ITEMS

ITEM NO.	DESCRIPTION	UNIT	QUANTITY
150-1000	TRAFFIC CONTROL	LUMP SUM	1
441-0104	CONC SIDEWALK, 4 IN	SY	148
441-5002	HEADER CURB, 6 IN, TP 2	LF	78
610-9001	REM SIGN	EA	6
615-1100	DIRECTIONAL BORE PIPE - 5 IN	LF	110
615-1100	DIRECTIONAL BORE PIPE - 7 IN	LF	125
636-1041	HIGHWAY SIGNS, TP 2 MATL, REFL SHEETING, TP 9	SF	77
639-3004	STEEL STRAIN POLE, TP IV (W/ 25 FT MAST ARM); (POWDER-COAT BLACK FINISH) *	EA	1
639-3004	STEEL STRAIN POLE, TP IV (W/ 55 FT MAST ARM); (POWDER-COAT BLACK FINISH) *	EA	1
639-3004	STEEL STRAIN POLE, TP IV (W/ 45 FT AND 50 FT MAST ARMS); (POWDER-COAT BLACK FINISH) *	EA	1
647-1000	TRAFFIC SIGNAL INSTALLATION NO. 1	LUMP SUM	1
653-0120	THERMOPLASTIC PVMT MARKING, ARROW, TP 2	EA	3
653-0230	THERMOPLASTIC PVMT MARKING, WORD, TP 3A**	EA	4
653-1501	THERMOPLASTIC SOLID TRAF STRIPE, 5 IN, WHITE	LF	240
653-1502	THERMOPLASTIC SOLID TRAF STRIPE, 5 IN, YELLOW	LF	280
653-1704	THERMOPLASTIC SOLID TRAF STRIPE, 24 IN, WHITE	LF	66
653-1804	THERMOPLASTIC SOLID TRAF STRIPE, 8 IN, WHITE	LF	535
653-3501	THERMOPLASTIC SKIP TRAF STRIPE, 5 IN, WHITE	GLF	100
653-6006	THERMOPLASTIC TRAF STRIPING, YELLOW	SY	193
654-1001	RAISED PVMT MARKERS TP 1	EA	22
654-1003	RAISED PVMT MARKERS TP 3	EA	7
682-6233	CONDUIT, NONMETAL, TP 3, 2 IN	LF	1180
682-8500	ELECTRICAL POWER SERVICE ASSEMBLY (AERIAL SERVICE POINT)***	EA	1
700-9300	SOD	SY	35
937-6000	MICROWAVE RADAR DETECTION ASSEMBLY	EA	6
937-8020	TESTING - MICROWAVE DETECTION SYSTEM	LUMP SUM	1
937-8520	TRAINING - MICROWAVE DETECTION SYSTEM	LUMP SUM	1
999-5200	DETECTABLE WARNING SURFACE	SF	75
999-9999	FLIR TRAFIONE 195 THERMAL DETECTION SYSTEM****	LUMP SUM	1

*THE CITY OF DECATUR WILL FURNISH THE MAST ARM ASSEMBLIES. CONTRACTOR SHALL COORDINATE WITH THE CITY TO OBTAIN.
 **CONTRACTOR SHALL COORDINATE WITH THE CITY REGARDING PLACEMENT OF 'SCHOOL' PAVEMENT MARKINGS.
 ***THE CONTRACTOR SHALL COORDINATE WITH GA POWER REGARDING POWER SERVICE POINT. PRICE SHOWN FOR ELECTRICAL POWER SERVICE ASSEMBLY (AERIAL SERVICE POINT) SHALL INCLUDE ALL NECESSARY COMPONENTS.
 ****THE ASSOCIATED FOR FLIR TRAFIONE 195 THERMAL DETECTION SYSTEM SHALL INCLUDE ALL NECESSARY COMPONENTS (I.E. DETECTOR UNITS, BRACKETS, CABINET COMPONENTS, WIRING, ETC.)

D3-1 OVERHEAD STREET NAME SIGN DETAILS

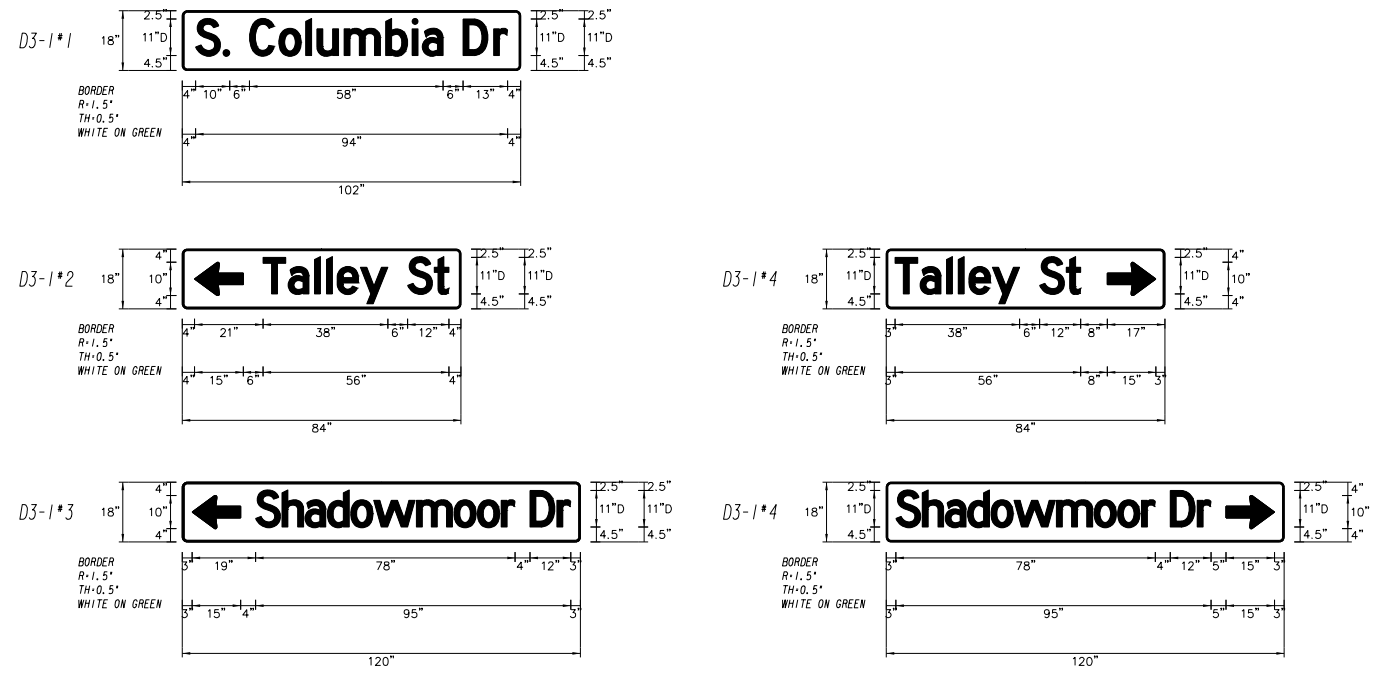

332 CABINET INPUT ASSIGNMENT

SLOT	1	2	3	4	5	6	7	8	9	10	11	12	13	14	
UPPER INPUT FILE															
	TYPE	DET	DET	DET	DET	DET	DET	DET	DET	DET	TBA	TBA	DC	DC	DC
	CARD	RADAR	RADAR			RADAR	RADAR						DC ISO	DC ISO	DC ISO
CHANNEL 1	C1 PIN	56	39	63	47	58	41	65	49	60		80	67	68	81
	FUNCTION	R1	R2A			R3	R4						# 2 PED	# 4 PED	FLASH SENSE
	FIELD TERM	TB2 1,2	TB2 5,6	TB2 9,10	TB4 1,2	TB4 5,6	TB4 9,10	TB6 1,2	TB6 5,6	TB6 9,10			TB8 4,6	TB8 7,9	N/C
CHANNEL 2	C1 PIN	56	43	76	47	58	45	78	49	62		53	69	70	82
	FUNCTION		R2B										# 3 PED	# 6 PED	STOP TIME
	FIELD TERM	TB2 3,4	TB2 7,8	TB2 11,12	TB4 3,4	TB4 7,8	TB4 11,12	TB6 3,4	TB6 7,8	TB6 11,12			TB8 5,6	TB8 8,9	N/C
LOWER INPUT FILE															
	TYPE	DET	DET	DET	DET	DET	DET	DET	DET	DET	TBA	TBA	DC	DC	DC
	CARD		RADAR												
CHANNEL 1	C1 PIN	55	40	64	48	57	42	66	50	59		54	71	72	51
	FUNCTION		R6												
	FIELD TERM	TB3 1,2	TB3 5,6	TB3 9,10	TB5 1,2	TB5 5,6	TB5 9,10	TB7 1,2	TB7 5,6	TB7 9,10			TB9 4,6	TB9 7,9	TB9 10,12
CHANNEL 2	C1 PIN	55	44	77	48	57	46	79	50	61		75	73	74	52
	FUNCTION														
	FIELD TERM	TB3 3,4	TB3 7,8	TB3 11,12	TB5 3,4	TB5 7,8	TB5 11,12	TB7 3,4	TB7 7,8	TB7 11,12			TB9 5,6	TB9 8,9	TB9 11,12



REVISION DATES

SIGNAL PLANS
 S COLUMBIA DR AT TALLEY ST/SHADOWMOOR DR
 SUMMARY OF QUANTITIES

CHECKED:	DATE:	DRAWING NO.
BACKCHECKED:	DATE:	27-006
CORRECTED:	DATE:	
VERIFIED:	DATE:	